

## 050-1100 - 8mm Single Rotor Latch - Two Position

## 050-1110 - 8mm Single Rotor Latch - Single Position



This robust automotive style single rotor latch is designed for light to medium duty applications for on or off-highway hoods, compartments and access panels. This design allows ease of interface with TriMark's range of external and internal methods of activation for application flexibility.

- Interior door thickness of 44mm (1.73") or greater
- Light to medium duty doors of 25 kg (55 lbs.) with door seal pressure no greater than 20 kg (40 lbs.)
- 8mm diameter hoop strike

### **FEATURES/BENEFITS:**

- Compact size and shape; allows maximum use of door space and minimizes visibility issues
- Rotor provides for vertical clearance of strike allowing for door sag, misalignment and ease of installation
- Modular case design provides for multiple latch actuation direction and locations for application flexibility

### **Global Locations:**

**TriMark Corporation**  
500 Bailey Avenue  
P.O. Box 350  
New Hampton, Iowa 50659  
United States  
Tel: 641-394-3188  
Fax: 641-394-2392  
1-800-447-0343  
www.trimarkcorp.com

**TriMark Europe**  
Unit 3 Sence Court  
Bardon Hill  
Coalville  
Leicestershire LE67 1GZ  
United Kingdom  
Tel: +44(0)1530 512460  
Fax: +44(0)1530 512461  
www.trimarkeu.com

**TriMark (Xuzhou)**  
Building A5 Jingwu Road  
Xuzhou Economic  
Development Zone  
Xuzhou, Jiangsu  
221004 PR China  
Tel: +86 516 8773 0018  
Fax: +86 516 8773 0058  
www.trimarkcn.com



TriMark. Interactive. Product. Selector



TriMark



TriMark Corporation



TriMark Corporation



# 050-1100 - 8mm Single Rotor Latch - Two Position

# 050-1110 - 8mm Single Rotor Latch - Single Position

### AVAILABLE:

- Versions are available to allow direct or remote actuation from exterior handles and interior releases
- Platform allows for reuse of existing actuation trip levers (050-0100)
- Multiple actuation directions and locations
- Standard 8.4mm diameter through axles or optional M8 X 1.25 threaded axles

### MATERIAL:

- Case halves: High strength steel
- Rotor and Catch: Heat-treated steel
- Springs: Non-corrosive stainless steel

### FINISH:

- Zinc plated, clear chromate steel components

### INSTALLATION:

- Easy to install, mounts with (2) M8 X 1.25 or 5/16 fasteners (not included)
- Tighten to the manufacturers' recommended torque value, however, do not exceed 22.2 N-m (200 in-lbs)
- Mount only to the front plate side

### U.S. Patent No. 8,075,027

Individual part dimensions are for reference only. Refer to individual part drawings for complete dimensions, specifications, and installation procedures. Engineering assistance and application drawings are available.

**CAUTION:** Latch does not meet FMVSS 206 (ECE R11) load requirements.

For more information visit  
[www.trimarkcorp.com](http://www.trimarkcorp.com)

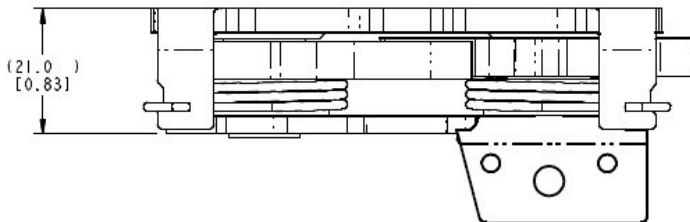

- 050-1100 8mm Single Rotor Latch - Two Position
- 050-1110 8mm Single Rotor Latch - Single Position

